

PREFABRICATED ... WALLS | FLOORS | ROOFS

Structural Insulated Panels

FOR COMMERCIAL AND RESIDENTIAL APPLICATIONS

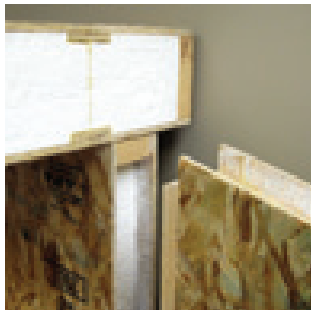

changing the way you think about modular

AUTHORIZED RESELLER OF GREENSMART SIPS

Construction

... now made easier, better, faster

“We are very impressed with Greensmart’s product knowledge and in-house design service capabilities. They have been a great partner for us. We are always pushing the envelope on what can be done to create a better home, and Greensmart has always provided quality service and support. We look forward to growing our company one SIP at a time.”

DARREN J. MATITY, GENERAL MANAGER
SUNSMART HOMES LTD

STRUCTURAL INSULATED PANELS (SIPs) are high-performance pre-fabricated building panels for walls, roofs, foundation walls, and floors.

Constructed with expanded polystyrene (EPS) rigid foam insulation, sandwiched between two oversized structural skins of oriented strand board (OSB), Greensmart high-performance panels are more energy efficient, cost effective and stronger

than typical on-site wood-frame construction. These pre-built panels are used in all types of structures, from residential to commercial buildings, including prefabricated modular units.

- **SAVE TIME:** Since the pre-built panels are built while the foundations are being laid, construction time is about 50% faster than typical wood-frame construction.
- **SAVE MONEY:** Save on labour costs and financing charges. Quick and easy installation cuts on-site construction time in half.
- **SAVE ENERGY:** SIP panels have an exceptionally high energy-efficiency rating. Since the panel is solid insulation, without the heat loss normally associated with breaks required for wood studs, SIP panels have twice the

insulating power of typical wood-frame construction. In fact, R-values exceed both the US Energy Star rating and the CMHC R2000 rating, and are far superior to a typical R-20 rated wall.

- **SAVE THE ENVIRONMENT:** Leading the industry with sustainable design principles, Greensmart SIP panels require less raw materials, generate less waste, and use environmentally-preferable building materials. For instance, the Oriented Strand Board (OSB) used in making the SIP panels are manufactured from a wide range of fast-growing trees once considered to be waste by the lumber industry. In addition, the Polystyrene insulation is a safe, non-toxic, clean product.
- **ENJOY BETTER QUALITY:** SIP panels are 3 times stronger, more durable and longer lasting than traditional stick-built structures. Built indoors, using kiln-dried lumber, and tightly sealed during fast on-site installation, SIP panels are not

subjected to moisture, insects and molds like typical site-built construction. This translates into a more solid fit, less cracks, virtually no nail pops, and ultimately less maintenance.

- **ENJOY INCREASED COMFORT:** Since SIP panels are so well insulated, they are substantially more sound resistant. Also because they are so tightly sealed, there is virtually no opportunity for insects, rodents or mold to take hold. And since the insulation is dust-free, residents can enjoy many years of comfortable, healthy living.

From pre-designed house packages to custom-designed commercial buildings, all Greensmart SIP panels are engineered to exacting requirements with precision factory-cutting. Rest assured that our in-house design team and manufacturing group will produce your SIP panels to the highest industry standards. With easy installation and our ongoing support, you will have a better building ... in much less time.

more energy efficient ... more cost effective ... better quality





INSULATED PANELS



MODULAR BUILDINGS

“Besides a quick installation, we wanted to build an energy efficient air-tight home. Greensmart’s SIPs seemed the best way to go. We have not been disappointed. As testimony to the high quality insulation, we have had no need for air conditioning ... and we don’t hear any outside noise at all. In addition, we didn’t need a vented attic and the subsequent ice-damming issues. We would highly recommend Greensmart’s SIPs.”

JOHN AND JANET ROBINSON, ROBINSON RESIDENTIAL DESIGN INC.



TEMPORARY STRUCTURES

Shelter Industries

Shelter Industries Inc. is an MBI-award winning modular building manufacturer, which has designed and built thousands of permanent and temporary buildings throughout the world since 1985. In 2009, Shelter Industries merged with Greensmart Manufacturing Ltd. Greensmart Manufacturing Ltd. is an award-winning company, recognized for their innovative design and development of their leading-edge, environmentally-friendly Structurally Insulated Panels, used in both on-site construction and in modular units. The new company, Greensmart Shelters Inc., now has offices in Calgary, Alberta; Dawson Creek, BC; Fort St. John, BC; and Aldergrove, BC.

AWARD WINNING MANUFACTURER

- “Sustainability Award” — Northern British Columbia Business and Technology Awards: Greensmart
- “Manufacturing Innovator of the Year Award” — Northern British Columbia Business and Technology Awards: Greensmart
- “Excellence in Innovation Award” — Sci-Tech North: Greensmart
- “Technology Implementer of the Year” award nominee: Greensmart
- “Technology Provider of the Year” (NBCBTA) award nominee: Greensmart
- “Modular Building Institute (MBI) Award” — Shelter Industries

SOME PREVIOUS PROJECTS:

FIRST NATIONS

- Teslin Tlingit Council

OIL OR GAS

- Encana
- CNR
- Talisman
- North Rock Resources
- STARS

ARCHITECTS/CONSULTANTS

- Field, Field, & Field
- Buildtech Resources

INTERNATIONAL

- Bahamas Housing Complex

“We chose Greensmart Shelters Inc. because they had the knowledge, experience, and willingness to provide top quality product within very tight construction deadlines.”

IAN BOYD, PROJECT DIRECTOR
BIRD GRAHAM SCHOOLS
(A JOINT VENTURE)

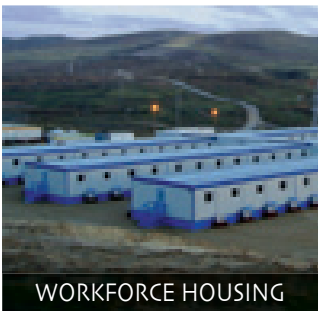

WORKFORCE HOUSING

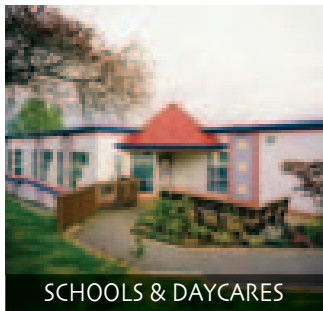

SCHOOLS & DAYCARES



HEALTHCARE



FIRST NATIONS

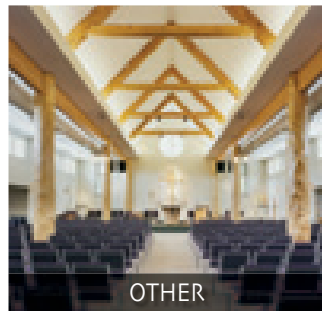

OTHER

STRUCTURAL INSULATED PANELS (SIPs)

- Prefabricated SIP Walls, Roofs, Floors and Foundation Walls.
- Pre-designed Housing Packages available. (See website for floor plans).
- Custom designed houses or commercial buildings (in-house design team).
- Factory precision-cut panels delivered direct, with full construction support.

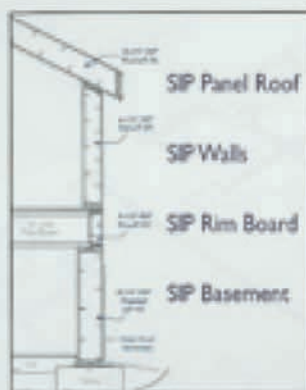

changing the way you think about modular

AUTHORIZED RESELLER OF GREENSMART SIPs

TOLL FREE: 1.800.561.3822

TEL: 1.604.856.1311

FAX: 1.604.856.5200

EMAIL: info@shelterindustries.com

HEAD OFFICE: 3294 - 262nd. Street

P.O. Box 1318, Aldergrove, BC

Canada, V4W 2V1

www.shelterindustries.com



Aldergrove, BC
Fort St. John, BC
Dawson Creek, BC
Calgary, AB

www.greensmartshelters.com